

ENLIT

SELECTION 2018

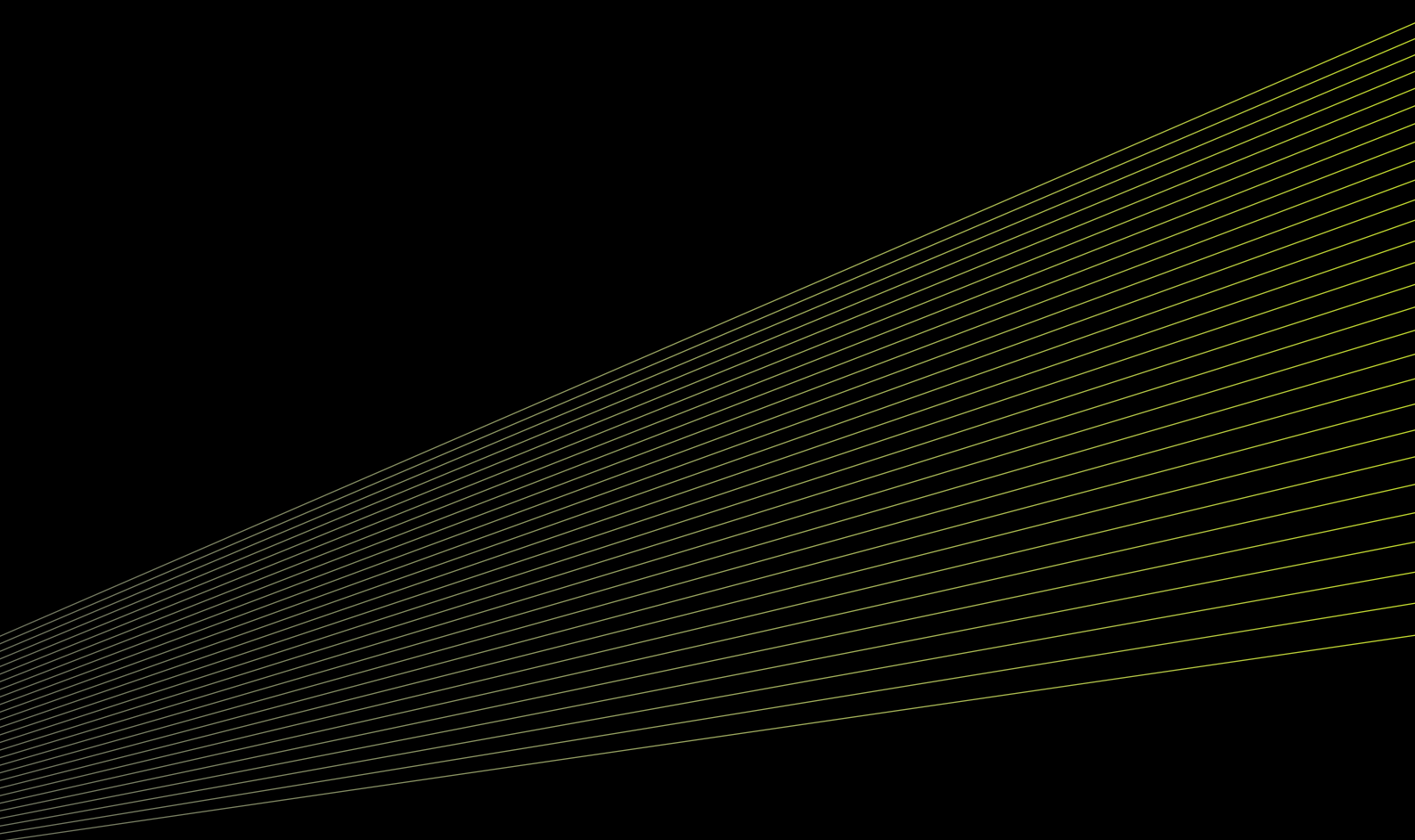

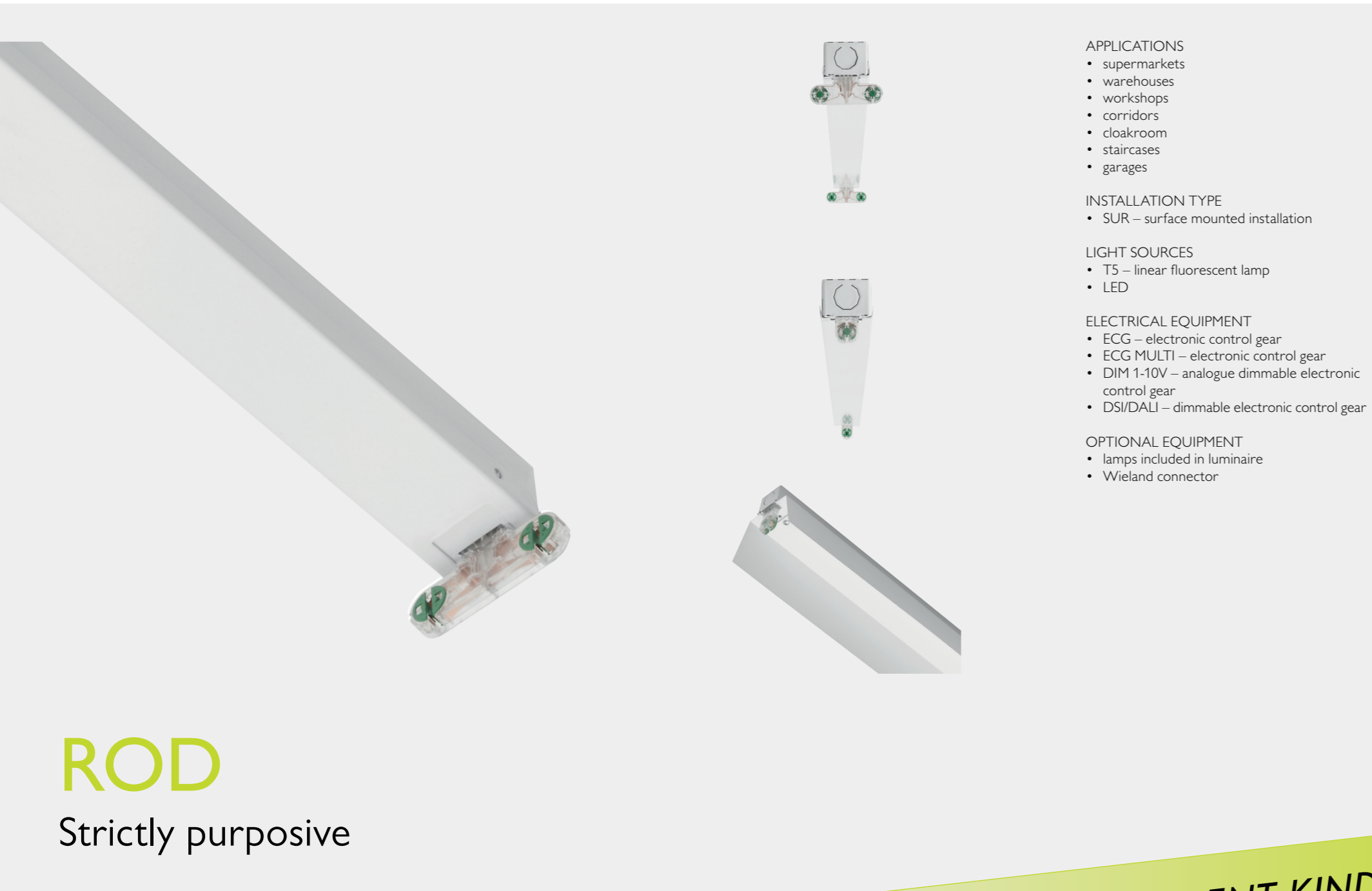

APPLICATIONS

- supermarkets
- warehouses
- workshops
- corridors
- cloakroom
- staircases
- garages

INSTALLATION TYPE

- SUR – surface mounted installation

LIGHT SOURCES

- T5 – linear fluorescent lamp
- LED

ELECTRICAL EQUIPMENT

- ECG – electronic control gear
- ECG MULTI – electronic control gear
- DIM 1-10V – analogue dimmable electronic control gear
- DSI/DALI – dimmable electronic control gear

OPTIONAL EQUIPMENT

- lamps included in luminaire
- Wieland connector

VALUE FOR PRICE

- 1 very compact fixture
- 2 different kind of optical systems available
- 3 through wiring
- 4 price
- 5 product fully manufactured and assembled in Slovakia

ROD

Strictly purposive

DIFFERENT KIND OF OPTICAL SYSTEMS AVAILABLE

VERY COMPACT FIXTURE

Simple luminaires with functional design are intended for providing of general illumination in undemanding interior applications. They could be equipped with one or two linear fluorescent lamps T5. Luminaires are designed for mounting on solid surface.

The main identification signs of this product range are simple construction, quick mounting and reasonable price.



ROD

T5



Luminaire is constructed to use with linear fluorescent lamps T5. Luminaire housing is made of sheet steel, surface treated with white powder coated colour. Electrical components – electronic control gear, terminal block and lampholders are placed inside the housing of luminaire. Two types of reflectors – symmetrical and asymmetrical are available as accessories. Luminaire is designed for direct mounting on solid surface.

Lamp	T5
Lamp holder	G5
Class	I
Ingress protection	IP20
Weight	3,9-7,1 kg

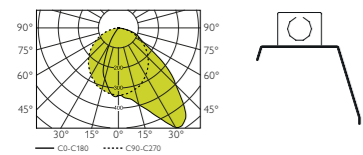

ROD RSA R11 T5 1x80W

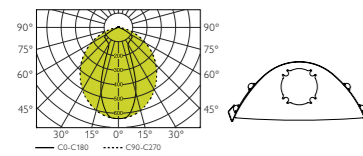

ROD RSSK T5 1x80W

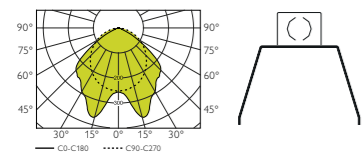

ROD RSS R01 T5 2x49W

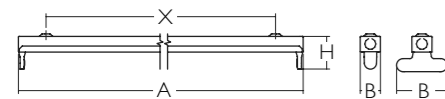

CODE TYPE

INSTALLATION TYPE

- SUR – surface mounted installation

OPTICAL SYSTEM

- available several types of symmetric, asymmetric specular reflectors and white reflectors

ELECTRICAL EQUIPMENT

- electronic control gear for linear fluorescent lamp T5
- lampholder G5
- 3-pole screwless terminal block, max. 2,5mm²
- cable opening entry completed with cable gland

OPTIONAL EQUIPMENT

- lamps included in luminaire
- Wieland connector

Type	A (mm)	B (mm)	H (mm)	X (mm)	kg
ROD T5 1x14W	570	42	62	460	0,7
ROD T5 1x24W	570	42	62	460	0,7
ROD T5 1x28W	1170	42	62	1060	1,1
ROD T5 1x54W	1170	42	62	1060	1,1
ROD T5 1x35W	1470	42	62	1360	1,3
ROD T5 1x49W	1470	42	62	1360	1,3
ROD T5 1x80W	1470	42	62	1360	1,3
ROD T5 2x14W	570	67	62	460	0,7
ROD T5 2x24W	570	67	62	460	0,7
ROD T5 2x28W	1170	67	62	1060	1,1
ROD T5 2x54W	1170	67	62	1060	1,1
ROD T5 2x35W	1470	67	62	1360	1,3
ROD T5 2x49W	1470	67	62	1360	1,3
ROD T5 2x80W	1470	67	62	1360	1,3

SPECIFICATION

control gear	optics	colour	lamp	emergency unit	accessories
ECG	RWS R01 T5	RAL 9003	14W/827, 14W/830, 14W/835, 14W/840, 14W/865, 24W/827, 24W/830, 24W/835, 24W/840, 24W/865, 24W/880, 24W/940, 24W/965, 28W/827, 28W/830, 28W/835, 28W/840, 28W/865, 54W/827, 54W/830, 54W/835, 54W/840, 54W/865, 54W/880, 54W/940, 54W/965, 35W/827, 35W/830, 35W/835, 35W/840, 35W/865, 80W/827, 80W/830, 80W/835, 80W/840, 80W/865, 80W/880, 80W/940, 80W/965	M 3h	
ECG-MULTI	RSS R01 T5				
DIM 1-10V	RSA R11 T5				
DSI	RSSK T5				
DALI	RSSKN T5				

RO000000T51014	ROD T5 1x14W
RO000000T51024	ROD T5 1x24W
RO000000T51028	ROD T5 1x28W
RO000000T51054	ROD T5 1x54W
RO000000T51035	ROD T5 1x35W
RO000000T51049	ROD T5 1x49W
RO000000T51080	ROD T5 1x80W
RO000000T52014	ROD T5 2x14W
RO000000T52024	ROD T5 2x24W
RO000000T52028	ROD T5 2x28W
RO000000T52054	ROD T5 2x54W
RO000000T52035	ROD T5 2x35W
RO000000T52049	ROD T5 2x49W
RO000000T52080	ROD T5 2x80W

ROD

OPTICAL SYSTEMS

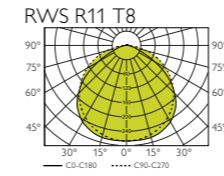

RWS R11 T8

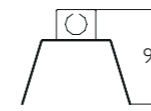

WHITE REFLECTOR WIDE BEAM 1xT8

Reflector designed for one lamp fixture ROD T8. Made of sheet steel, surface treated with white powder coated colour. Direct light distribution, wide beam angle. Application for lower mounting heights and uniform general illumination.

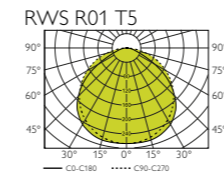

RWS R01 T5

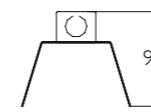

WHITE REFLECTOR WIDE BEAM 1xT5, 2xT5

Reflector designed for one and two lamp fixture ROD T5. Made of sheet steel, surface treated with white powder coated colour. Direct light distribution, wide beam angle. Application for lower mounting heights and uniform general illumination.

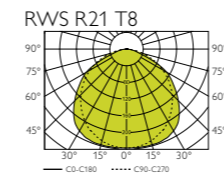

RWS R21 T8

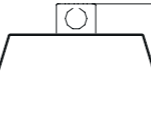

WHITE REFLECTOR WIDE BEAM 2xT8

Reflector designed for two lamp fixture ROD T8. Made of sheet steel, surface treated with white powder coated colour. Direct light distribution, wide beam angle. Application for lower mounting heights and uniform general illumination.

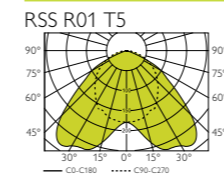

RSS R01 T5

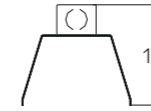

AL REFLECTOR WIDE BEAM – 1xT5, 2xT5

Reflector designed for one or two lamp fixture ROD T5. Reflector made of anodised aluminium. Direct light distribution, wide beam angle.

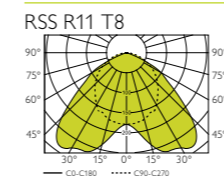

RSS R11 T8

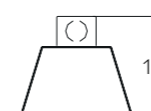

AL REFLECTOR WIDE BEAM – 1xT8

Reflector designed for one lamp fixture ROD T8. Reflector made of anodised aluminium. Direct light distribution, wide beam angle.

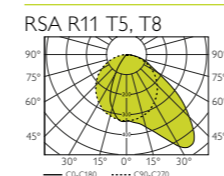

RSA R11 T5, T8

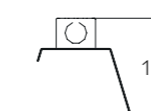

ASYMMETRICAL AL REFLECTOR – 1xT5, 1xT8

Reflector designed for one lamp fixture ROD T5 or ROD T8. Made of anodised aluminium. Asymmetric light distribution. Application for lighting of shelves, displayed goods or another vertical surfaces.

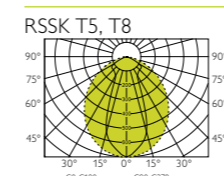

RSSK T5, T8

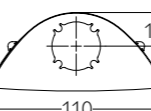

AL REFLECTOR NARROW BEAM – 1xT5, 1xT8

Reflector designed for one lamp fixture ROD T5 or ROD T8. Made of plastic with aluminium reflective layer. Mounting directly to lamp. Direct light distribution, narrow beam angle. Application for high mounting heights.

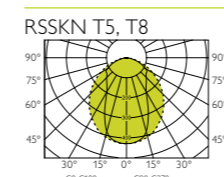

RSSKN T5, T8

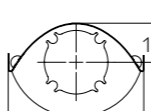

AL REFLECTOR WIDE BEAM – 1xT5, 1xT8, 2xT8

Reflector designed for one lamp fixture ROD T5 or one and two lamp fixture ROD T8. Made of plastic with aluminium reflective layer. Mounting directly to lamp. Direct light distribution, wide beam angle.

ROD LED

RWS, RWS/RSS

Simple luminaire with functional design, designed to provide general illumination in wide range of interior applications. Although its look reminds older fluorescent relatives, it is equipped with last generation of linear LED modules, that are covered with frosted diffuser. Diffuser not only protect LED boards from direct touch, it also helps to spread the light homogenously into space, without any multi-shadow effect.

Standardly available with reflector accessory – whether white painted or made of high reflective anodised aluminium.

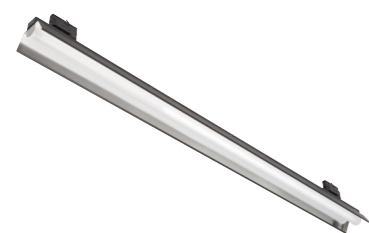

Lamp	LED
Cooling	PASSIVE
Class	I
Ingress protection	IP20
Weight	2,6 kg

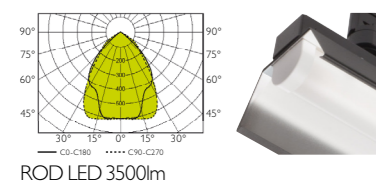

INSTALLATION TYPE

- SUR – mounting on solid surfaces
- SUS – suspended luminaire
- TRC – installation into (one or three-circuit) lighting track (Global, Eutrac)

OPTICAL SYSTEM

- RWS - reflector white symmetric
- RWS/RSS - high efficient reflector made of anodised aluminium inserted into outer steel reflector

ELECTRICAL EQUIPMENT

- linear LED modules fixed on aluminium mounting plate
- electronic LED driver
- adapter for mounting into the lighting track (optional)

OPTIONAL EQUIPMENT

- wiring with emergency unit (1 or 3h)
- wiring with dimmable electronic control gear (DSI, DALI)
- black colour finish
- suspensions

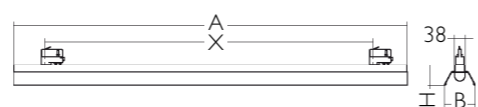

Type*	System power (W)	Equivalent	A/X (mm)	B (mm)	H (mm)	kg
ROD LED 3500lm	32	1x54W T5	1440/1200	113	72	2,6
ROD LED 4300lm	40	1x80W T5	1440/1200	113	72	2,6

*net lumen output of the luminaire

CODE	TYPE	SPECIFICATION
		cct
		optics
		cri
		control gear
		colour
		accessories
RL000000LE03500	ROD LED 3500lm	Tunable White (3000K-6000K)
RL000000LE04300	ROD LED 4300lm	3000K
		4000K
		6500K
		RWS
		RWS/RSS
		80
		90
		ECG
		DALI
		DIM1-10V
		DSI
		white
		black
		M1h
		M3h
		TRC
		SUS



enlighten your world

ENLIT spol. s r. o.

Priemyselná 1497/18b
905 01 Senica
Slovakia

T +421 905 556 800
T +421 915 089 654
E info@enlit.sk

www.enlit.sk